

SuplR 4.5mm f/1.1, Fixed Athermalized 680284

TYPICAL ICD*

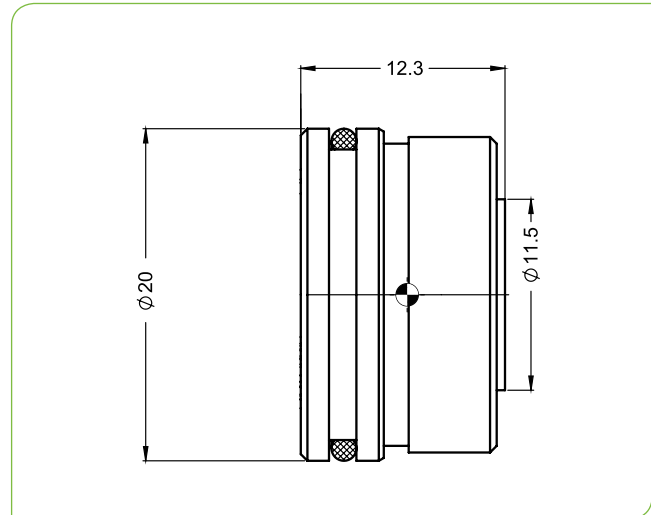

HFOV	320x240
12μ	48.5°
10μ	40.3°

LWIR | 1-FOV

Property		Value			
Optical					
Focal Length		4.5mm			
F#		1.1			
Average transmission (8-12μm)		94% (HD) / 92% (HC)			
Back Focal Length		6.3mm in air			
Mechanical					
Focus Mechanism		Fixed			
Depth of Field		1m to infinity			
Focus Range		0.1m to infinity			
Weight		8gr			
Max. Dimensions		Ø20.0mm x 12.3mm			
Environmental					
Operation Temperature		-40°C to +80°C			
Storage Temperature		-54°C to +85°C			
Sealing		IP 67 front element only			
Configurations	Weight (gr)	Dimensions	BWD**	Thread	Coating
680284-001	8	Ø20.0mm x 12.3mm	7.2	M19x0.5	HD
680284-002					HC

* The ICD drawing provided here is primarily a representation and may not accurately reflect the product's actual dimensions and specifications. For precise integration specifications contact your local sales representative.

** The BWD value is calculated for a unique detector setup with varying sealing windows in terms of thickness and material. For more details, contact your local sales representative.