

SuplR 14.25mm f/1.3, Fixed Athermalized 65183

TYPICAL ICD*

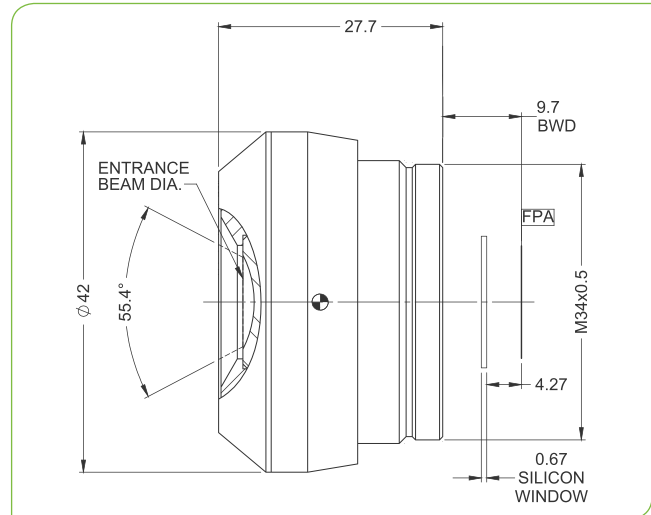

**HD
FORMAT**



HFOV	320x240	384x288	640x480	1024x768
17μ	21.9°	26.3°	44.0°	
12μ	15.4°	18.5°	30.9°	49.8°

LWIR | 1-FOV

Property			Value		
Optical					
Focal Length			14.25mm		
F#			1.3		
Average transmission (8-12μm)			93% (HD) / 88% (HC)		
Back Focal Length			15.35mm in air		
Mechanical					
Focus Mechanism			Fixed Focus		
Depth of Field			15m to infinity		
Focus Range			0.6m to infinity		
Weight			see configuration table below		
Max. Dimensions			see configuration table below		
Environmental					
Operation Temperature			-40°C to +80°C		
Storage Temperature			-40°C to +90°C		
Sealing			IP 67 front element only		
Configurations	Weight (gr)	Dimensions	BWD**	Thread	Coating
65183-04	49	Ø42mm x 32.3mm	6.84	M34x0.5	HD
65183-05	57	Ø41.5mm x 24.2mm	15.4	M41x0.75	
65183-06	49	Ø42mm x 32.3mm	6.84	M34x0.5	HC
65183-13	44.5	Ø42mm x 27.7mm	9.7	M34x0.5	HC
65183-15					HC, MWIR block filter

* The ICD drawing provided here is primarily a representation and may not accurately reflect the product's actual dimensions and specifications. For precise integration specifications contact your local sales representative.

** The BWD value is calculated for a unique detector setup with varying sealing windows in terms of thickness and material. For more details, contact your local sales representative.