

SupIR 25mm f/1.0, Manual Focus 680319*

TYPICAL ICD*

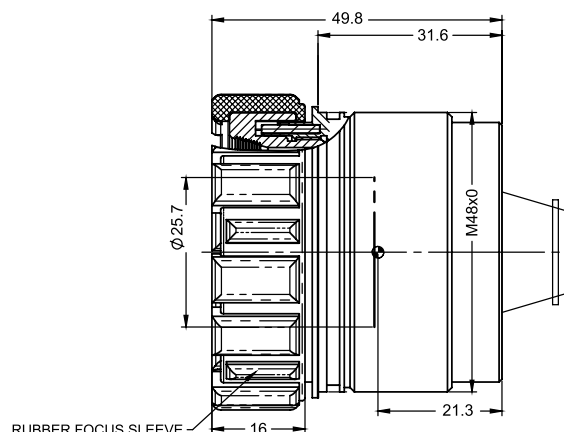

HD
FORMAT



HFOV	320x240	384x288	640x480	1024x768
17μ	12.4°	14.8°	24.4°	
12μ	8.8°	10.5°	17.4°	27.4°

Property		Value			
Optical					
Focal Length		25mm			
F#		1.0			
Average transmission (8-12μm)		90% (HC)			
Back Focal Length		13.46mm in air			
Mechanical					
Focus Mechanism		Manual			
Depth of Field		16m to infinity			
Focus Range		1.0m to infinity			
Weight		134gr			
Max. Dimensions		Ø54mm x 49.8mm			
Environmental					
Operation Temperature		-40°C to +70°C			
Storage Temperature		-50°C to +80°C			
Sealing		IP 67 front element only			
Configurations	Weight (gr)	Dimensions	BWD**	Thread	Coating
680319-001	134	Ø54mm x 49.8mm	12.15	M48x0.75	HD
680319-002					HC

* Requires export license

* The ICD drawing provided here is primarily a representation and may not accurately reflect the product's actual dimensions and specifications. For precise integration specifications contact your local sales representative.

** The BWD value is calculated for a unique detector setup with varying sealing windows in terms of thickness and material. For more details, contact your local sales representative.