

SupIR 65mm f/1.25, Manual Focus 680061

TYPICAL ICD*

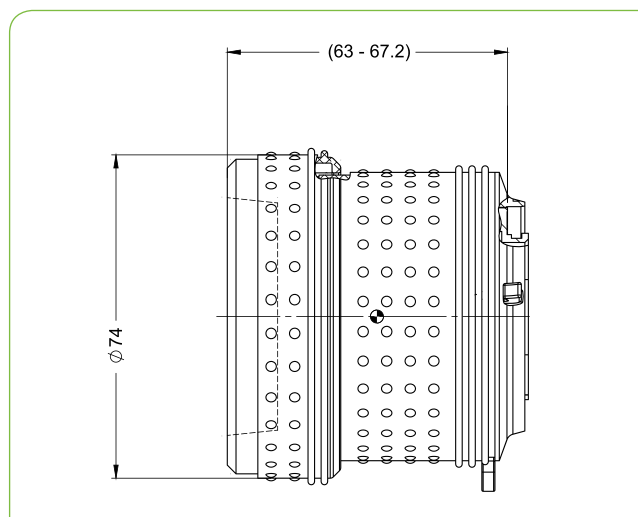

HD
FORMAT



HFOV	320x240	384x288	640x480	1024x768
17μ	4.8°	5.7°	9.6°	
12μ	3.4°	4.1°	6.8°	10.8°

Property			Value		
Optical					
Focal Length			65mm		
F#			1.25		
Average transmission (8-12μm)			89% (HC)		
Back Focal Length			25.76mm in air		
Mechanical					
Focus Mechanism			Manual		
Depth of Field			175m to infinity		
Focus Range			2.5m to infinity		
Weight			373gr		
Max. Dimensions			Ø74mm x (63.0-67.2)mm		
Environmental					
Operation Temperature			-40°C to +80°C		
Storage Temperature			-55°C to +85°C		
Sealing			IP 67 front element only		
Configurations	Weight (gr)	Dimensions	BWD**	Thread	Coating
680061-003	373	Ø74mm x (63.0-67.2)mm	15	Bayonet	HC

* The ICD drawing provided here is primarily a representation and may not accurately reflect the product's actual dimensions and specifications. For precise integration specifications contact your local sales representative.

** The BWD value is calculated for a unique detector setup with varying sealing windows in terms of thickness and material. For more details, contact your local sales representative.