

SuplR 16.7mm f/1.25, Fixed Athermalized 680186

TYPICAL ICD*

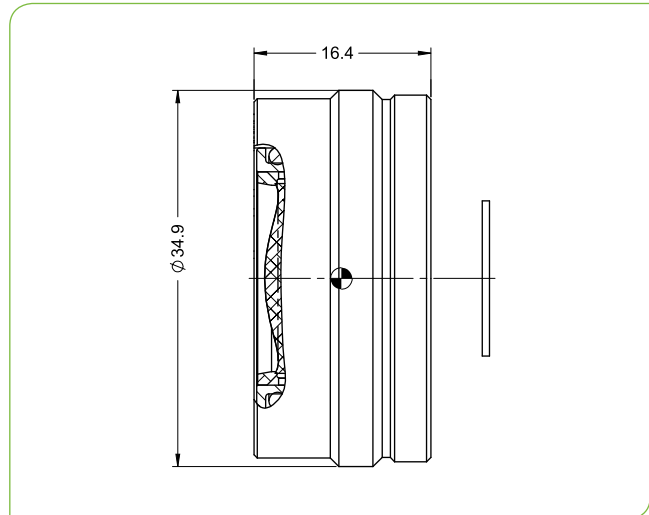

HFOV	320x240	384x288	640x480
17μ	18.7°	22.4°	37.5°
12μ	13.2°	15.8°	26.4°

LWIR | 1-FOV

Property			Value		
Optical					
Focal Length			16.7mm		
F#			1.25		
Average transmission (8-12μm)			94% (HD)		
Back Focal Length			11.41mm in air		
Mechanical					
Focus Mechanism			Fixed		
Depth of Field			10m to infinity		
Focus Range			1.4m to infinity		
Weight			25.5gr		
Max. Dimensions			Ø34.9mm x 16.4mm		
Environmental					
Operation Temperature			-40°C to +80°C		
Storage Temperature			-50°C to +85°C		
Sealing			IP 67 front element only		
Configurations	Weight (gr)	Dimensions	BWD**	Thread	Coating
680186-003	25.5	Ø34.9mm x 16.4mm	9.7	M34x0.5	HD
680186-004					HC
680186-007					HE
680186-005	34	Ø34.9mm x 19.74mm	6.64		HD
680186-006					HC

* The ICD drawing provided here is primarily a representation and may not accurately reflect the product's actual dimensions and specifications. For precise integration specifications contact your local sales representative.

** The BWD value is calculated for a unique detector setup with varying sealing windows in terms of thickness and material. For more details, contact your local sales representative.