

SuplR 13.6mm f/1.0, Fixed Athermalized 680412

TYPICAL ICD*

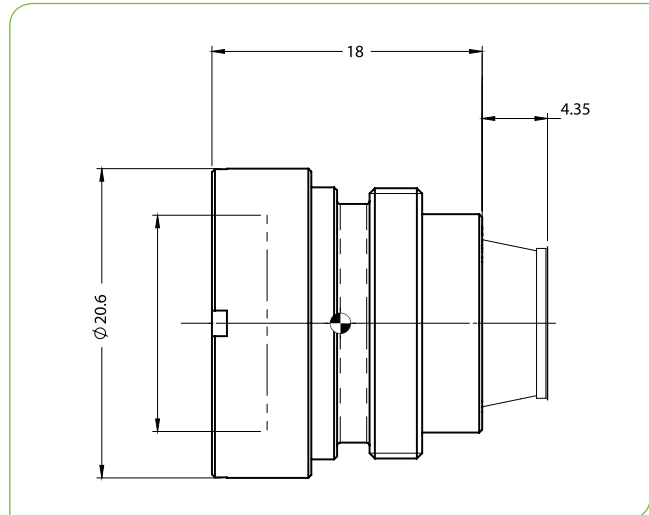

HFOV	320x240	384x288	640x480
17μ	22.8°	27.3°	
12μ	16.2°	19.3°	32.0°
10μ	13.5°	16.2°	26.8°

LWIR | 1-FOV

Property		Value			
Optical					
Focal Length		13.6mm			
F#		1.0			
Average transmission (8-12μm)		91% (HD) / 88% (LRHC)			
Back Focal Length		4.8mm in air			
Mechanical					
Focus Mechanism		Fixed			
Depth of Field		9m to infinity			
Focus Range		1m to infinity			
Weight		12.7gr			
Max. Dimensions		Ø20.6mm x 18mm			
Environmental					
Operation Temperature		-40°C to +80°C			
Storage Temperature		-50°C to +85°C			
Sealing		IP 67 front element only			
Configurations	Weight (gr)	Dimensions	BWD**	Thread	Coating
680412-003	12.7	Ø20.6mm x 18mm	4.35	M18x0.5	HD
680412-004					LRHC***

* The ICD drawing provided here is primarily a representation and may not accurately reflect the product's actual dimensions and specifications. For precise integration specifications contact your local sales representative.

** The BWD value is calculated for a unique detector setup with varying sealing windows in terms of thickness and material. For more details, contact your local sales representative.

*** For detailed LRHC coating specifications see page 13