

SuplR 3.8mm f/1.4, Fixed Athermalized 680235

TYPICAL ICD*

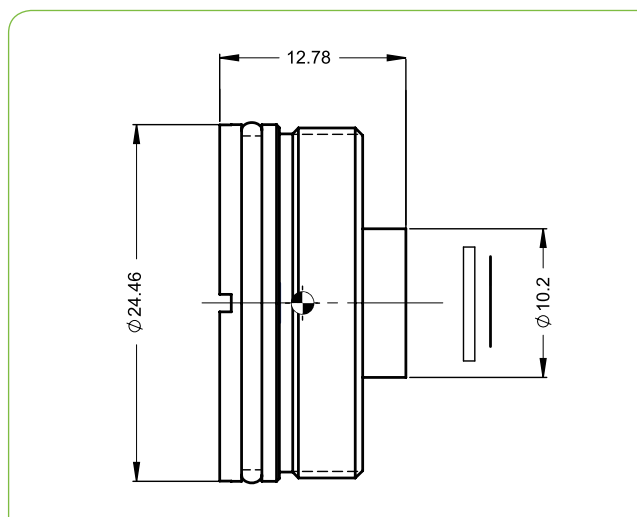

HFOV	320x240
17μ	89.9°
12μ	60.3°

Property			Value		
Optical					
Focal Length			3.8mm		
F#			1.4		
Average transmission (8-12μm)			95% (HD) / 90% (HC)		
Back Focal Length			5.5mm in air		
Mechanical					
Focus Mechanism			Fixed		
Depth of Field			1m to infinity		
Focus Range			0.1m to infinity		
Weight			see configurations table below		
Max. Dimensions			see configurations table below		
Environmental					
Operation Temperature			-40°C to +80°C		
Storage Temperature			-50°C to +85°C		
Sealing			IP 67 front element only		
Configurations	Weight (gr)	Dimensions	BWD**	Thread	Coating
680235-001	10.8	Ø24.46mm x 12.78mm	5.8	M24x0.5	HD
680235-002					HC
680235-003	9.9	Ø20.5mm x 13.8mm	3.31	M19x0.5	HD
680235-004					HC

* The ICD drawing provided here is primarily a representation and may not accurately reflect the product's actual dimensions and specifications. For precise integration specifications contact your local sales representative.

** The BWD value is calculated for a unique detector setup with varying sealing windows in terms of thickness and material. For more details, contact your local sales representative.