

SupIR 20mm f/0.85, Fixed Focus 65037

TYPICAL ICD*

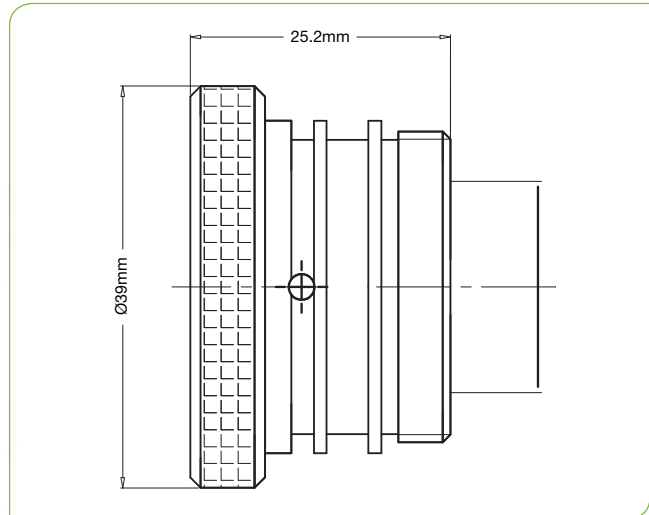

HD
FORMAT



HFOV	320x240	384x288	640x480	1024x768
17μ	15.9°	19.0°	30.9°	
12μ	11.3°	13.5°	22.5°	34.5°

Property		Value			
Optical					
Focal Length		20mm			
F#		0.85			
Average transmission (8-12μm)		85% (HC)			
Back Focal Length		8.27mm in air			
Mechanical					
Focus Mechanism		Fixed			
Depth of Field		40m to infinity			
Focus Range		1.8m to infinity			
Weight		36gr			
Max. Dimensions		Ø39mm x 25.2mm			
Environmental					
Operation Temperature		-32°C to +49°C			
Storage Temperature		-33°C to +71°C			
Sealing		IP 67 front element only			
Configurations	Weight (gr)	Dimensions	BWD**	Thread	Coating
65037-02	36	Ø39mm x 25.2mm	7.2	1.1875-24 UNS	HC
65037-03					HD

* The ICD drawing provided here is primarily a representation and may not accurately reflect the product's actual dimensions and specifications. For precise integration specifications contact your local sales representative.

** The BWD value is calculated for a unique detector setup with varying sealing windows in terms of thickness and material. For more details, contact your local sales representative.