

SuplR 50mm f/1.2, Fixed Athermalized 680114

TYPICAL ICD*

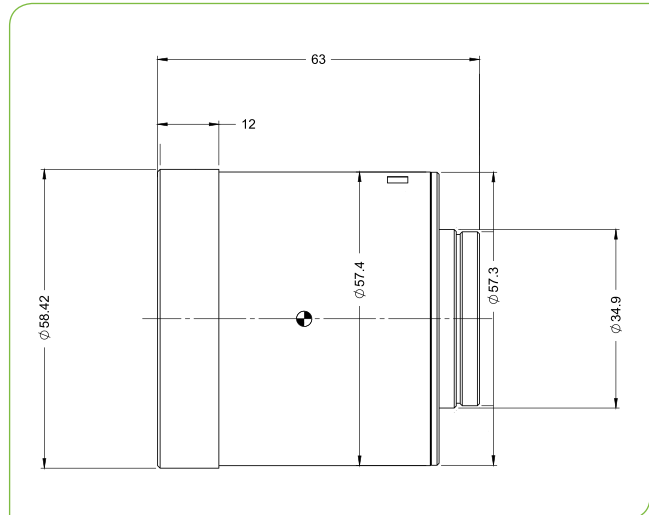

HD
FORMAT



HFOV	320x240	384x288	640x480	1024x768
17μ	6.2°	7.5°	12.4°	
12μ	4.4°	5.3°	8.8°	14.0°

Property		Value			
Optical					
Focal Length		50mm			
F#		1.2			
Average transmission (8-12μm)		94% (HD) / 88% (HC)			
Back Focal Length		33.68mm in air			
Mechanical					
Focus Mechanism		Fixed			
Depth of Field		100m to infinity			
Focus Range		1.5m to infinity			
Weight		238gr			
Max. Dimensions		Ø58.42mm x 63mm			
Environmental					
Operation Temperature		-40°C to +80°C			
Storage Temperature		-55°C to +85°C			
Sealing		IP 67 front element only			
Configurations	Weight (gr)	Dimensions	BWD**	Thread	Coating
680114-001	238	Ø58.4mm x 63mm	9.7	M34x0.5	HD
680114-002					HC
680114-005***					HC

* The ICD drawing provided here is primarily a representation and may not accurately reflect the product's actual dimensions and specifications. For precise integration specifications contact your local sales representative.

** The BWD value is calculated for a unique detector setup with varying sealing windows in terms of thickness and material. For more details, contact your local sales representative.

*** Completely sealed