

SupIR 18-225mm f/4, Motorized Continuous Zoom 680473

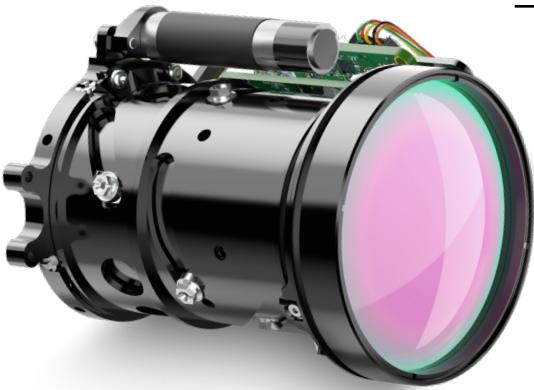

HD
FORMAT

WFOV (18mm)

HFOV	640x512	1280x720	1280x1024
15μ	29.9°		
10μ	20.2°	39.1°	39.1°

NFOV (225mm)

HFOV	640x512	1280x720	1280x1024
15μ	2.4°		
10μ	1.6°	3.3°	3.3°

Property

Value

Optical

Focal Length

WFOV

18mm

NFOV

225mm

Average transmission (3.4-4.9μm)

≥80% (HCLR) / ≥87% (HD)

Cold stop to FPA Distance

19.4mm

Cold Stop CA

Ø4.88mm (for 19.2-20.5mm CSH)

Back Focal Length

26.9mm in air (with 1+0.5mm Ge windows)

Minimum Focusing Range

5m

50m

Nuc (by defocus)

Yes

Mechanical

Focus Mechanism

Motorized. Adjustable

Focus Time (minimum range to ∞)

<2 sec.

Zoom Time (NFOV to WFOV)

<5 sec.

Max. Dimensions

Ø61.4 x 84mm

Weight

324gr

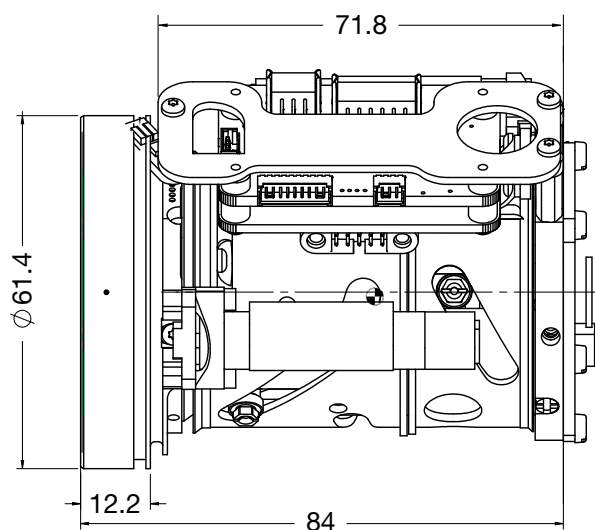

Property	Value
Electrical	
Lens Control	Designated lens controller
Supply Voltage	12V
Current Consumption	< 0.5A average, 1.0A peak
Communication Protocol	RS422
Environmental	
Operation Temperature	-32°C to +80°C
Storage Temperature	-54°C to +85°C
Sealing	IP67 front element only
Configurations	
680473-001	HD
680473-002	LRHC**
680473-003	HD, shutter for 19.4mm CSH
680473-004	LRHC**, shutter for 19.4mm CSH

* NOTE: The ICD drawing provided here is primarily a representation and may not accurately reflect the product's actual dimensions and specifications. For precise integration specifications contact your local sales representative.

** For detailed LRHC coating specifications see page 13