

1.1.1.2 Round Photodiode Sensors

500pW to 3W

Features

- Round geometry for easy centering
- Threaded to fit standard SM1 bench equipment
- Same performance as standard PD300 sensors
- Comes with removable filter as standard
- • Fiber optic adapters available

PD300R Filter Off



PD300R Filter installed



Model	PD300R		PD300R-3W		PD300R-IR				
Use	General		Powers to 3W		IR wavelengths 700-1800nm				
Detector Type	silicon		silicon		Germanium				
Aperture	Ø10mm		Ø10mm		Ø5mm				
Calibration Uncertainty ± %	1.1 430-1000nm ^(a)		1.1 430-1000nm ^(a)		2.4 700-1430nm ^(a)				
Filter Mode	Filter out	Filter in	Filter out	Filter in	Filter out	Filter in			
Spectral Range nm	350-1100	430-1100	350-1100	430-1100	700-1800	700-1800			
Power Range	500pW to 30mW	2µW to 300mW	5nW to 100mW	2µW to 3W	5nW to 30mW	2µW to 300mW			
Power Scales	30mW to 30nW and dBm	300mW to 300µW and dBm	100mW to 300nW and dBm	3W to 300µW and dBm	30mW to 30nW and dBm	300mW to 300µW and dBm			
Resolution nW	0.01	NA	0.1	NA	0.01	NA			
Maximum Power vs. Wavelength	nm	mW	nm	mW	nm	mW			
	<488	30	300	<488	100	3000	800	12	120
	633	20	300	633	100	3000	1000-1300	30	300
	670	13	200	670	100	2000	1400	30	250
	790	10	100	790	100	1200	1500	30	100
	904	10	100	904	100	1200	1600	30	100
	1064	25	250	1064	100	2200	1800	30	300

Accuracy (including errors due to temp. variations)

% error vs Wavelength nm	±10	360-400	NA	±10	360-400	NA	±5	700-800	±6	700-900		
	±3	400-980	±5	430-980	±3	400-950	±5	430-950	±4	800-1700	±5	900-1700
	±5	980-1100	±7	980-1100	±4	950-1030	±6	950-1030	±7	1700-1800	±9	1700-1800
				±6	1030-1100	±7	1030-1100					
Damage Threshold W/cm ²	10	50	10	30	10	50						
Max Pulse Energy µJ	2	20	20	500	0.3	3						
Noise Level for filter out pW	20		200		200							
Response Time with Meter s	0.2		0.2		0.2							
Beam Position Dependence	±2%		±2%		±3%		±2%					
Fiber Adapters Available (see page 33)	ST, FC, SMA, SC		ST, FC, SMA, SC		ST, FC, SMA, SC							
Compliance	CE, UKCA, China RoHS		CE, UKCA, China RoHS		CE, UKCA, China RoHS							
Version												
Part Number	7Z02436		7Z02437		7Z02439							

Note: (a) For calibration uncertainty of wavelengths outside of this range see table on page 24

* For graphs see page 31-32

PD300R / PD300R-3W

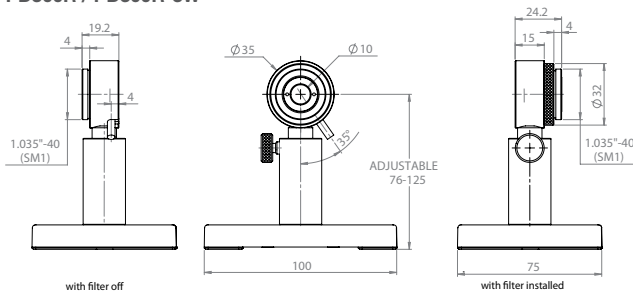

PD300R-IR

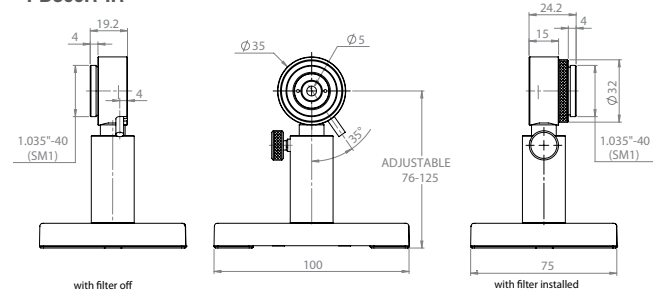

1.1.1.4 Graphs

Temperature Coefficient of Sensitivity

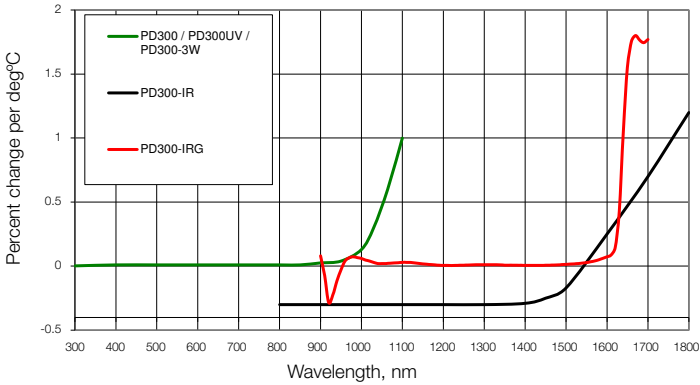

PD300 Angle Dependence

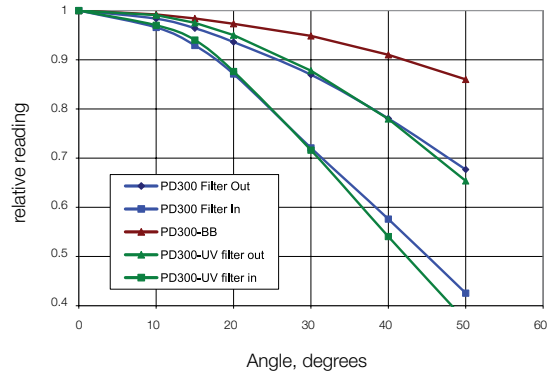

Dependence of Sensitivity on Numerical Aperture (PD300 - IRG)

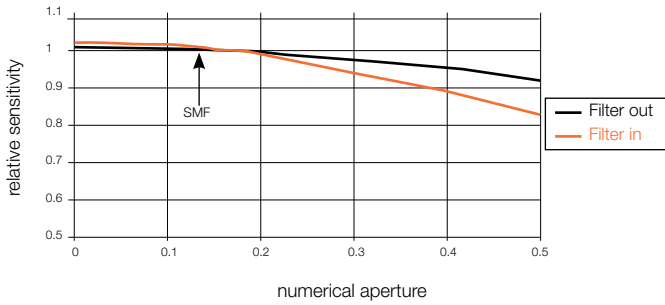

- Note:
1. Graph assumes equal intensity into all angles up to maximum N.A.
 2. Calibration is done with SMF, N.A. 0.13

PD300-CIE Spectral Response vs. CIE Curve

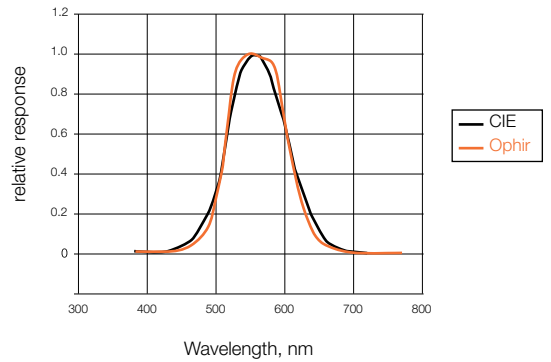

Typical Sensitivity Curve of PD300-BB Sensors

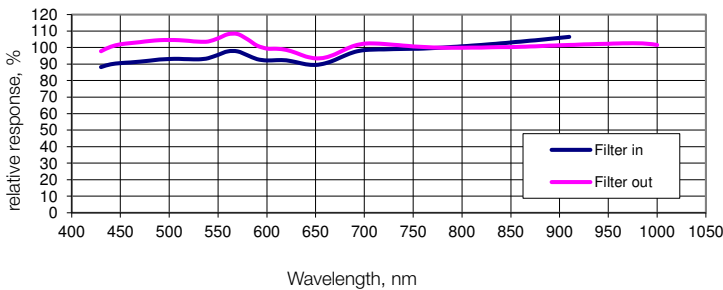

BC20 Relative Spectral Response

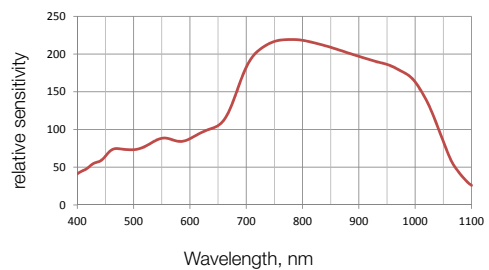

Approximate Spectral Response

Relative to 633nm or 1550nm

PD300 / PD300R

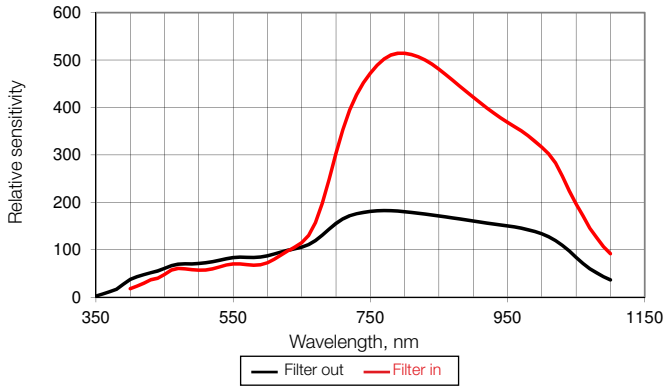

PD300-UV / PD300R-UV

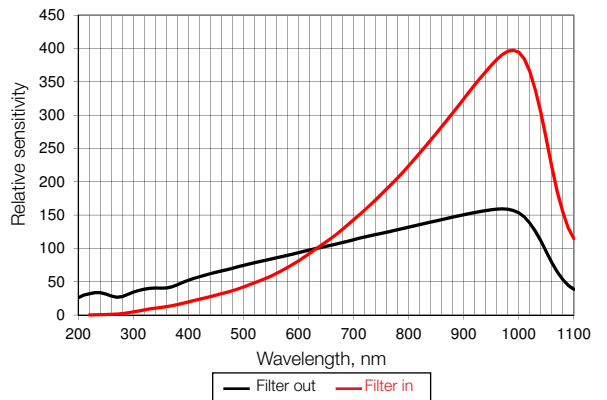

PD300-IR / PD300R-IR

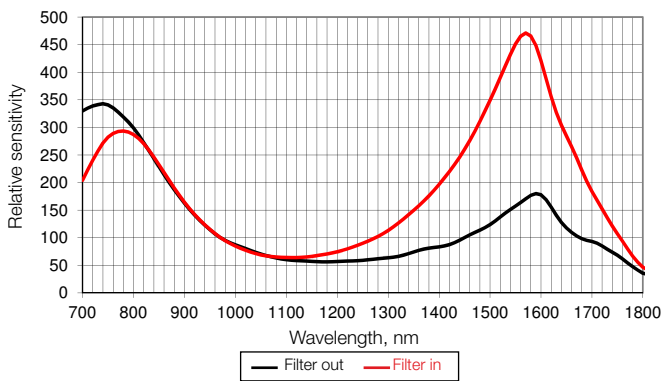

PD300-TP

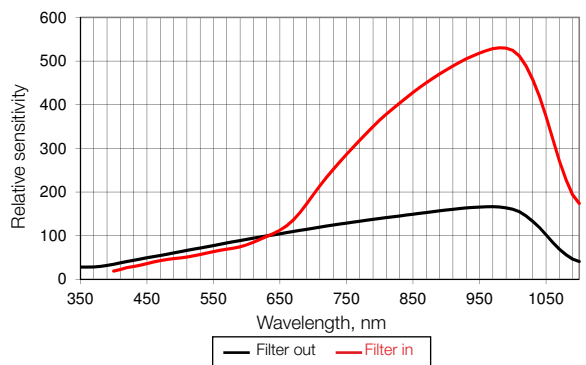

PD300-3W / PD300R-3W

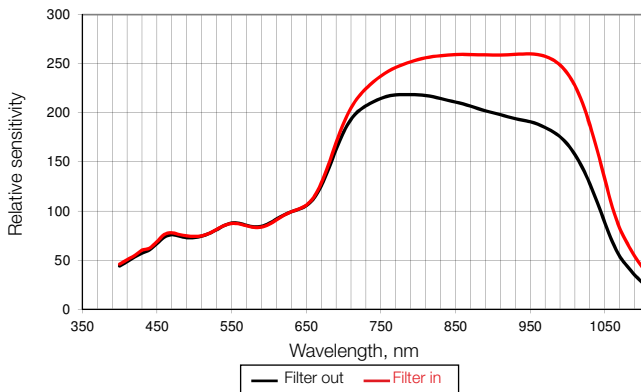

PD300-IRG

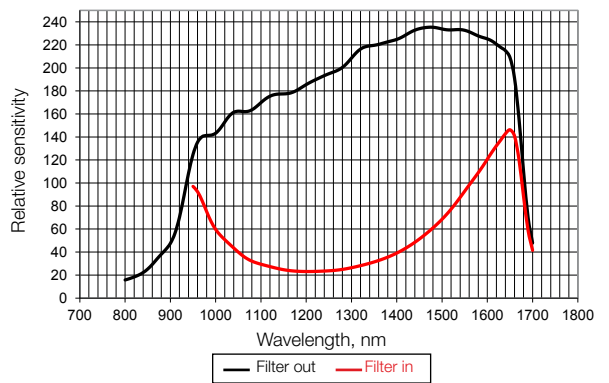

PD300-1W

