

30A-N

CW & Pulsed Measurements 60mW - 30W 30mJ - 200J

Recommended Use: Concentrated beam YAG lasers

Special Features: High damage threshold for high power density

Absorber:	N type: 1064nm, 532nm
Aperture:	φ 17.5mm
Digital Power Scales:	30W / 3W
Maximum Average Power Density:	5KW/cm ²
Power Noise Level:	3mW
Power Accuracy:	±3%
Maximum Energy Density J/cm ² :	
1 μs	1
0.5ms	20
>5ms	>100
Response Time with Display (0-95%):	2s typ
Linearity with Power:	± 1%
Energy Scales:	200J / 30J / 3J
Energy Threshold:	30mJ
Cooling:	Convection

30A-N

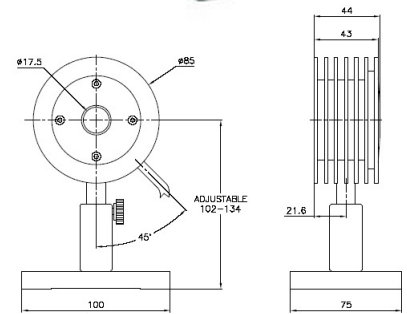

L30A

CW & Pulsed Measurements 80mW - 30W 20mJ - 30J

Recommended Use: Divergent beams, medium apertures

Special Features: 29mm aperture, 30 Watts

Absorber:	Broadband, 0.19-20μm
Aperture:	φ 29mm
Digital Power Scales:	30W / 3W
Maximum Average Power Density:	25KW/cm ²
Power Noise Level:	4mW
Power Accuracy:	±3%
Maximum Energy Density J/cm ² :	
<100ns	0.3
0.5ms	5
2ms	10
10ms	30
Response Time with Display (0-95%):	1.5s
Linearity with Power:	± 1% to 15W, ±1.5% to 25W
Energy Scales:	30J / 3J / 300mJ
Energy Threshold:	20mJ
Cooling:	Convection

L30A

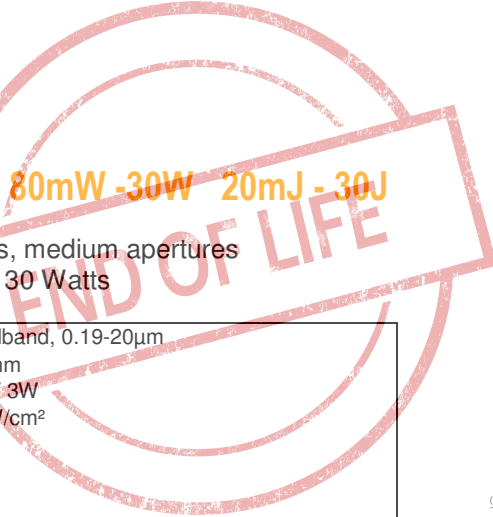
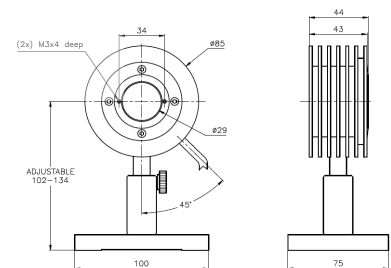

Ordering information		
Item	Description	Ophir P/N
30A-N	30W power/energy meter for concentrated or high energy YAG beams	1Z02003 / 7Z02003 (RoHS)
L30A-V1	Medium aperture 30 Watt power/energy meter	1Z02603 / 7Z02603 (RoHS)

Rev3-07/spc/05.06.07/eg

Visit our website: WWW.OPHIROPT.COM

