

SupIR 9.3mm f/1.3, Manual Focus 680269

TYPICAL ICD

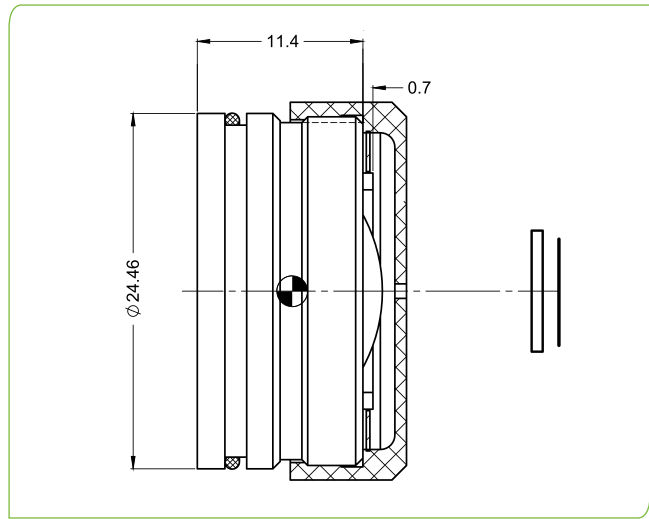

HFOV	160x120	320x240	384x288	640x480
25μ	25.0°			
17μ	17.0°	34.0°		
12μ	12.0°	24.0°	28.7°	48.1°
10μ			24.0°	40.0°

Property	Value
Optical	
Focal Length	9.3mm
F/#	1.3
Average transmission (8-12μm)	88%
Back Focal Length	11.6mm in air
Mechanical	
Focus Mechanism	Fixed
Focus Range	0.5m to infinity
Depth of field	5m to infinity
Max. Dimensions	Ø24.46mm x 12.1mm
Weight	16gr
Environmental	
Operation Temperature	-40°C to +85°C
Storage Temperature	-40°C to +85°C
Sealing	IP67 front element only
Configurations	
680269 - 001	High Durability
680269 - 002	Hard Carbon