

SupIR 13.6mm f/1.0, Fixed Athermalized 680412

TYPICAL ICD

NEW

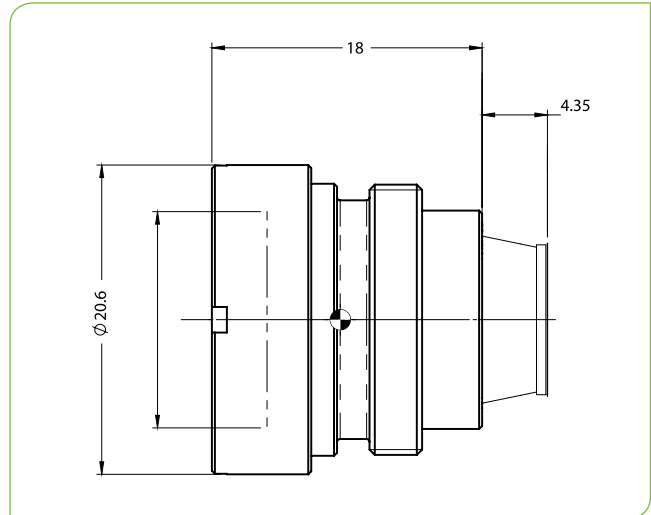

HFOV	160x120	320x240	384x288	640x480
25μ	16.8°	33.3°	40.0°	
17μ	11.5°	22.8°	27.3°	
12μ	8.1°	16.2°	19.3°	32.0°
10μ	6.8°	13.5°	16.2°	29.8°

Property	Value
Optical	
Focal Length	13.6mm
F/#	1.0
Average Transmission (8-12μm)	86% (HD); 89% (HC)
Back Focal Length	4.8mm in air
Mechanical	
Focus Mechanism	Fixed
Depth of Field	9m to infinity
Focus Range	1m to infinity
Weight	12.5gr
Max. Dimensions	Ø20.6 x 18mm
Environmental	
Operating Temperature	-40°C to +80°C
Storage Temperature	-50°C to +85°C
Sealing	IP 67 front element only
Configurations	
680412-001	High Durability
680412-002	Hard Carbon